

KL16K6T12V4
6 TO 12 INCH GRIP RANGE
16,000 POUND MAXIMUM CAPACITY
HANDLES 20 - 30 FOOT JERSEY WALL
UNIT WEIGHT - 750 POUNDS
AUTOMATIC LATCHING MECHANISM: ACTUATOR, LG
ELASTOMER PADS: (2) 6 X 36

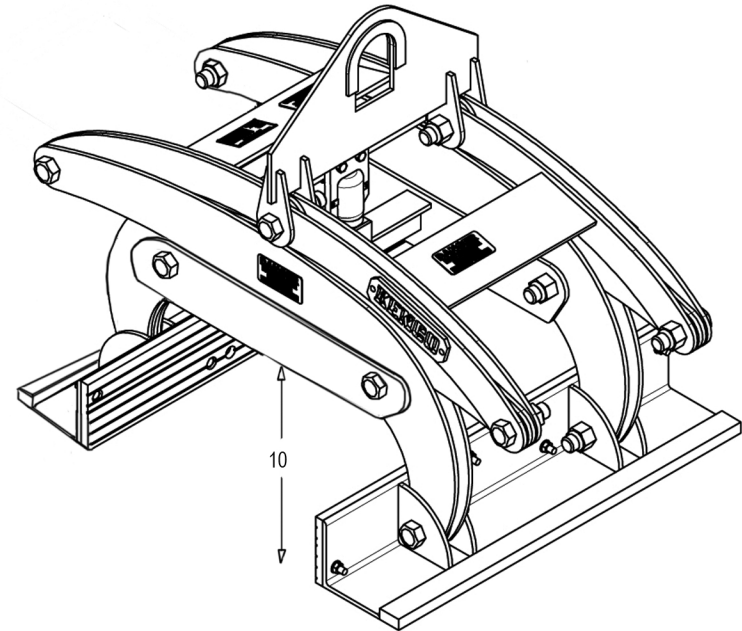

DRAWN BY:

N/A

DATE:

N/A



KENCO CORP.
 170 STATE ROUTE 271
 LIGONIER PA 15658

(800)653-6069

WWW.KENCO.COM

THE INFORMATION PROVIDED WITHIN THIS
 DRAWING IS THE PROPERTY OF KENCO CORP. ANY
 REPRODUCTION, TRANSMITTAL, OR USAGE OF ANY
 KIND IS PROHIBITED WITHOUT WRITTEN PERMISSION.

WEIGHT

750 lbs

CAPACITY

16000 lbs

DESCRIPTION

KL16K6T12
 BARRIER LIFT
 16,000 POUND CAPACITY
 GENERAL DIMENSIONS

PART NO.

N/A

REVISION