

Attachment Solutions

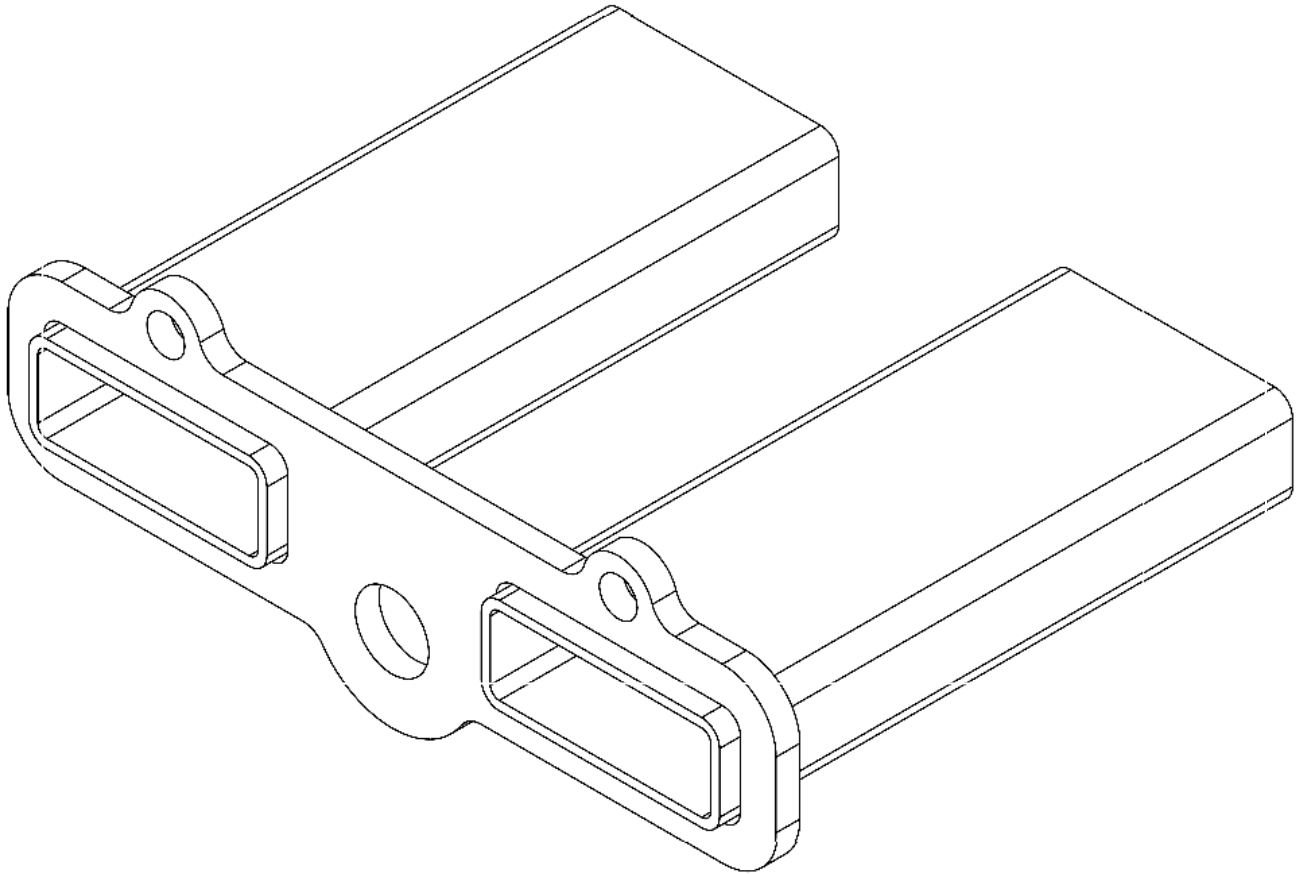

**Forklift Adapter
Lifting Eye Attachment
Operators Manual
Conforms to ASME B 30.20, BTH-1
Design Category B, Service Class 3**



170 State Route 271
Ligonier, PA 15658
1-800-653-6069

TABLE OF CONTENTS

Section I. General Information.....3

Section II. Safety.....3

Section III. Identification of Major Components5

Section IV. Setup.....5

Section V. Operation.....6

Section VI. Maintenance8

Section VII. Inspection Criteria.....9

Section VIII. Warranty10

RECORD INFORMATION HERE

FOR REFERENCE

MODEL	
BODY SERIAL NUMBER	
Notes:	



Section I. General Information.

May we take this opportunity to thank you for purchasing the Kenco Forklift Adapter. The Forklift Adapter provides the ultimate in forklift below the hook handling versatility. The Forklift Adapter is quality engineered to provide years of trouble free, low maintenance performance. **Please read and fully understand this manual and any additional attached documentation before attempting to setup, operate or maintain the Forklift Adapter system.**

This manual should be made available to all persons who may use or maintain the Forklift Adapter system. For additional information, please feel free to contact the service department at Kenco at 1-800-653-6069

Section II. Safety

A. General

1. Safety practices described in this manual are intended as guidelines for safe operation under most conditions and are supplementary to any and all rules and/or laws governing any aspect of the Kenco Forklift Adapter operation that are in force in your area.
2. Before operating the Kenco Forklift Adapter, you should have a clear understanding of said laws and regulations to ensure compliance.
3. Throughout this manual there are parts tagged with one or more of the following safety warnings. Particular care must be exercised with regard to these statements.



This warning is used where there is a high probability of death or serious injury if the instructions are not followed correctly.



This warning is used where there is a possibility of injury to yourself or others if the instructions are not followed correctly.



This warning is used where there is a possibility of damage to the machine if the instructions are not followed correctly.



170 State Route 271
Ligonier, PA 15658
1-800-653-6069

B. Personal Safety

1. Wear appropriate protective clothing and related safety equipment including protective glasses, hardhat, gloves, protective shoes, hearing protection, and any other equipment/devices dictated by job conditions.
2. Do not wear loose clothing, jewelry, or hairstyles that could become entangled in the Kenco Forklift Adapter or rigging hardware.
3. Keep hands, feet, and any other appendages clear of the Forklift Adapter while in operation.

C. Operation Safety.

1. **DO NOT ATTEMPT TO OPERATE OR PERFORM MAINTENANCE ON THE FORKLIFT ADAPTER UNTIL READING AND FULLY UNDERSTANDING THIS MANUAL**
2. **MAINTAIN SAFE DISTANCE FROM LOAD - NEVER ALLOW THE FORKLIFT ADAPTER OR LOAD TO PASS OVER ANY PART OF A PERSON.**
3. **DO NOT USE A KENCO FORKLIFT ADAPTER THAT HAS BEEN ALTERED ACCIDENTALLY OR INTENTIONALLY, IN ANY WAY WITHOUT INSPECTION BY QUALIFIED PERSONNEL.**
4. **DO NOT USE A KENCO FORKLIFT ADAPTER FOR ANY TASK OTHER THAN THE INTENDED PURPOSE OF THE DESIGN.**

Section III. Identification of Major Components

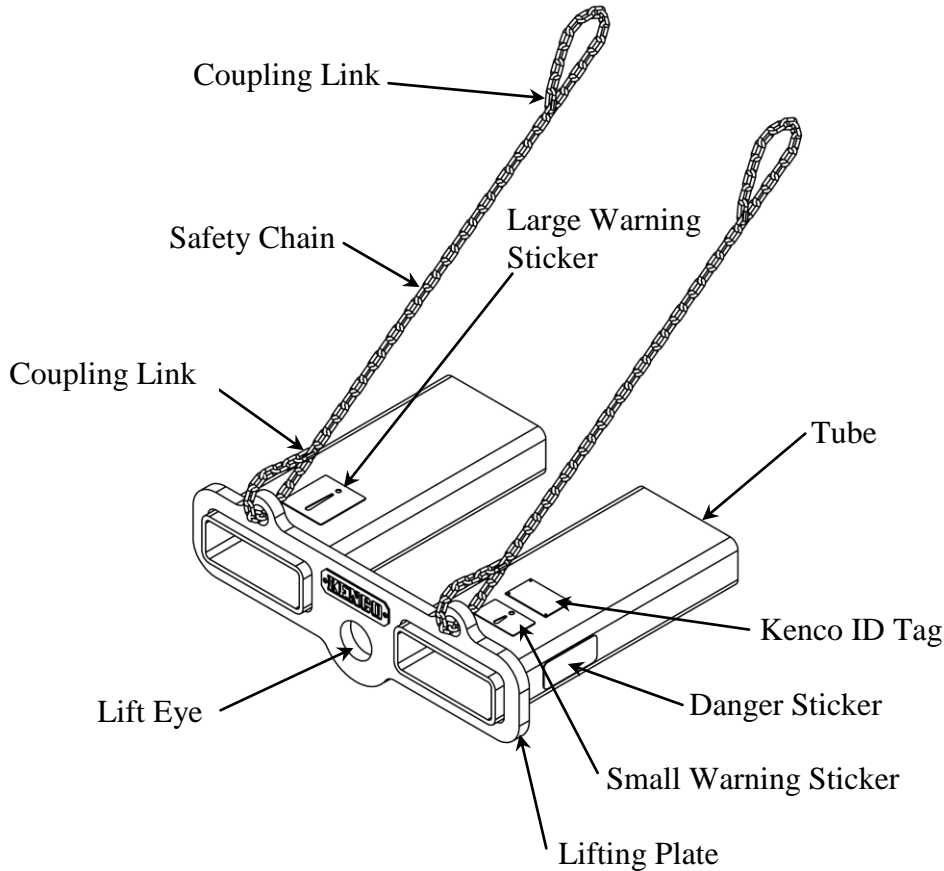

Section IV. Setup.

- A. Check the Forklift Adapter for any signs of damage incurred during shipping.
- B. Record model and serial # of assembly and components.
- C. Attach the Forklift Adapter to forklift.
 1. Use as few rigging components (shackles, slings, chain, etc.) as possible.
 2. **ALL RIGGING COMPONENTS MUST HAVE A WORKING LOAD LIMIT THAT IS EQUAL TO OR GREATER THAN THE COMBINED WEIGHT OF INTENDED LOAD PLUS ANY LIFTING APPARATUS THAT MAY BE USED FOR LOAD HANDLING.**
 3. **DO NOT RIG UNPROTECTED NYLON SLINGS OR WIRE ROPE DIRECTLY THROUGH LIFT EYE.**
 4. **USE RIGGING OF SUFFICIENT LENGTH TO PREVENT CONTACT BETWEEN FORKLIFT ADAPTER AND EQUIPMENT.**

Section V. Operation.



*Before attempting to use the Forklift Adapter device **ALWAYS** perform a test lift on the intended object(s) to confirm proper operation. **DO NOT** use a Forklift Adapter to handle objects beyond the rated capacity.*



KEEP ALL HANDS AWAY FROM THE FORKLIFT ADAPTER DURING OPERATION.

A. Operation:

1. Center forks on bulkhead at the required spacing for the adapter.
2. Place forks through tubes of the adapter and slide as close as possible to the bulkhead. (Forklift adapter may be used with lifteye at either end, clearance permitting). See illustration next page.
3. Once adapter is on forks, attach safety chains, lanyards, or straps to the attachment rings on the adapter. Provide no slack in safety equipment, be certain that attachment can not slide off of forks.
4. Before use ensure that all safety devices are in place, do not over exceed rated capacities of forklift, adapter, safety attachment, or lifting device(if applicable).
5. Lifting is to be done from the lifteye hole only. A shackle of at least the same rated capacity as the forklift adapter is recommended to connect the forklift adapter to the rigging. All rigging capacities should exceed the weight of the load and any other device connected to the adapter.
6. When in use, keep forks with slight rearward tilt to avoid sliding of adapter on forks.
7. Avoid jarring, swinging and otherwise unnecessary manipulation of the load.
8. Do not use the system to pick loads off center, drag a load or attempt to pick up a load that will not tolerate such a lift, that may break or split and cause an out of balance condition.
9. Observe all safety practices associated with forklift and crane operation.



DANGER *The safety chains only keep the forklift adapter in position until a load is lifted. It is up to the operator to keep the forks tilted in such a manor to keep the forklift adaptor from sliding. The safety chains are not designed or rated to keep the forklift adapter and combined load from sliding off of the forks.*

B. Avoid Jarring, swinging, and otherwise unnecessary manipulation of the load.

C. Avoid handling of loads off center.

D. DO NOT USE THE FORKLIFT ADAPTER TO PICK MULTIPLES OF ITEMS IN A SINGLE PICK.

E. Observe all safety practices associated with operation of hoist machinery.

F. DO NOT USE FORKLIFT ADAPTER TO DRAG LOADS.

G. DO NOT ALLOW LOAD (BLOCK) TO CONTACT ANY SURFACE/OBJECT WHILE BEING HANDLED.

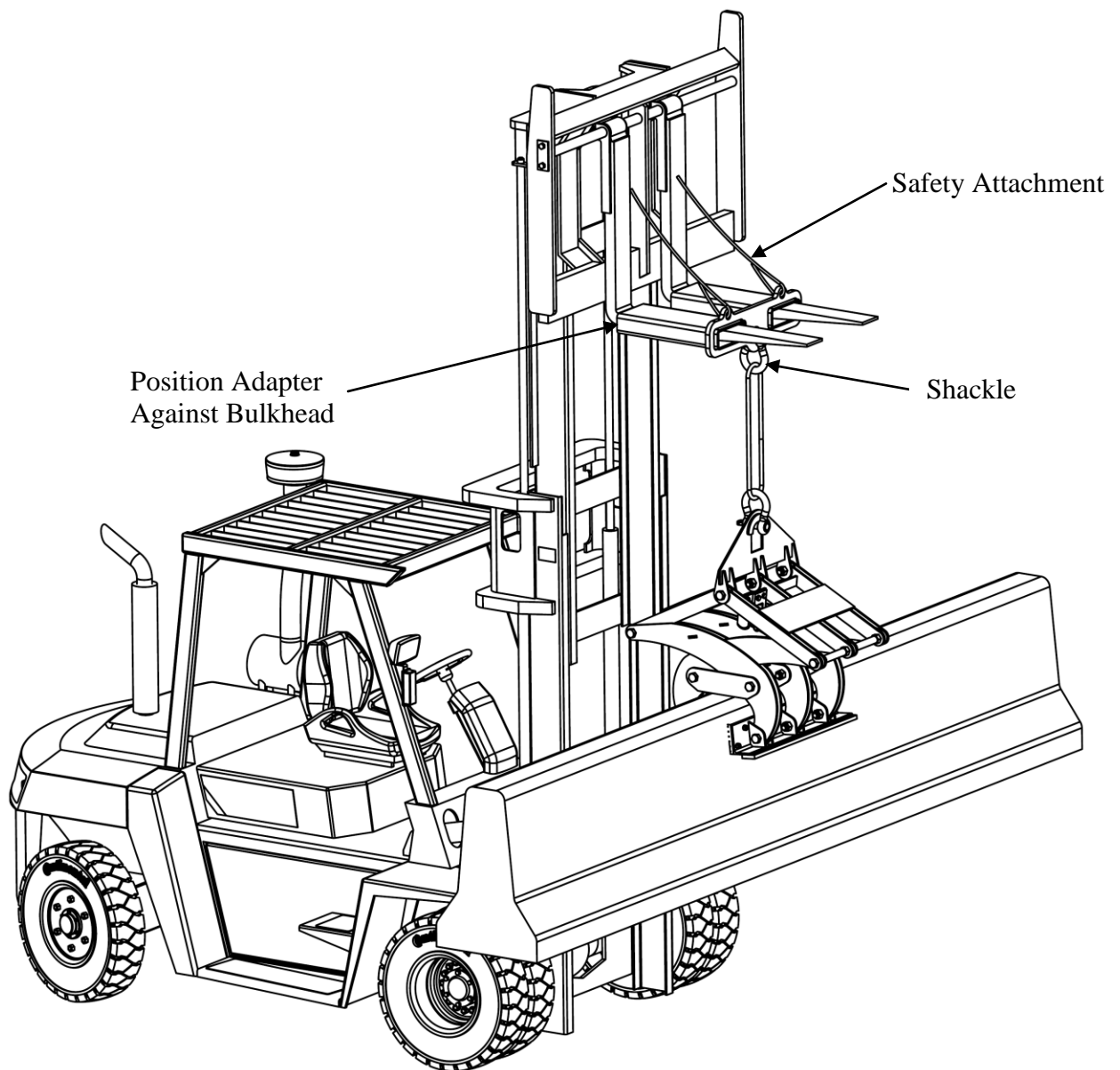



170 State Route 271
Ligonier, PA 15658
1-800-653-6069

Section VI. Maintenance

A. Daily:

1. Visually inspect Forklift Adapter for signs of stress and wear.
2. Check safety chains and couplers for damage.
3. Ensure that all warning labels are present and readable.

B. Annually*

1. Inspect holes, pins, bolts etc. for wear. See sect VII for criteria.

* *Frequency depends on usage, environmental conditions, etc.*

Section VII. Inspection Criteria

THE FORKLIFT ADAPTER UNIT AND ALL OF ITS ASSOCIATED COMPONENTS SHALL BE REMOVED FROM SERVICE AND TAGGED APPROPRIATELY UNTIL RECERTIFICATION BY A QUALIFIED INDIVIDUAL IN ANY OF THE FOLLOWING CONDITIONS:

A. General

1. Cracking in any component or member.
2. Cracking in any weld.
3. Visible distortion in any member.
4. Visible distortion in any Bolt/Pin/Shaft.

B. Specific

1. Lift Eye

- a. The lift eye shall be replaced if a 20% loss in cross-sectional area from the original member(s) can be demonstrated. Note: cross section of welds, “mushroomed” wear faces, and burrs are not accounted for as cross-sectional area. (See ill.)

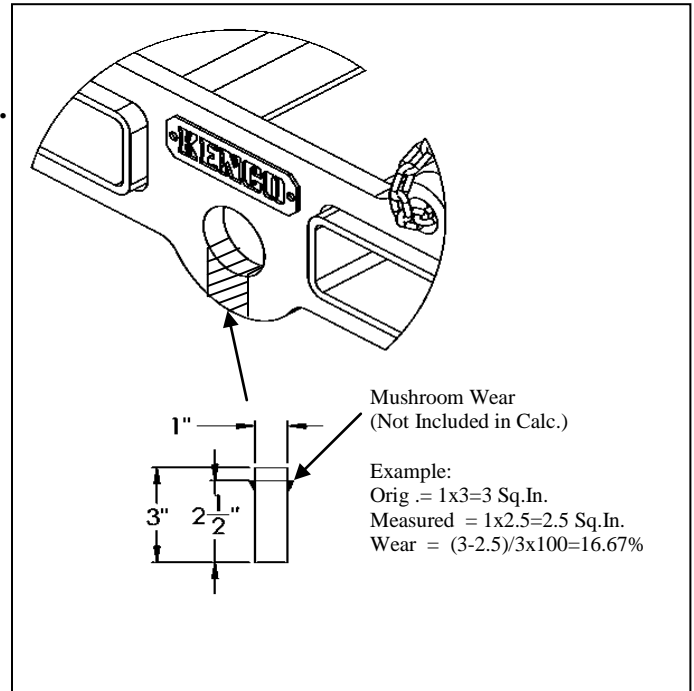

2. Holes.

- a. Any members through which bolted or pinned connections pass shall be replaced if a 10% loss in cross-sectional area from the original member(s) can be demonstrated. Note: cross section of welds, “mushroomed” wear faces, and burrs are not accounted for as cross-sectional area.



Section VIII. Warranty

A. Policy

1. KENCO Corporation (KENCO) warrants the Kenco Forklift Adapter lifting device (not including pads or consumable items) sold by KENCO to be free from proven defects in material and workmanship for a period of six (6) months from the delivery date to the original customer.
2. Warranty is limited to replacement of parts and/or assemblies, which upon inspection by KENCO are deemed to be defective in material, workmanship, or both.
3. Warranty shall not extend to products that have been altered or repaired in any way without the express written consent of KENCO.
4. Warranty shall not extend to any product that has been misused, abused, or improperly applied or any defect resulting thereof.
5. Defects and corrosion that are the result of improper storage and/or maintenance are not warrantable.
6. Wear items such as Pads, Pins or Lifting bails etc. are not considered for warranty claims.

B. Disclaimer

1. THIS WARRANTY IS EXCLUSIVE AND IN LIEU OF ALL OTHER REPRESENTATIONS AND WARRANTIES EXPRESSED OR IMPLIED, AND KENCO EXPLICITLY DISCLAIMS AND EXCLUDES ANY IMPLIED WARRANTY OF MERCHANTABILITY FOR A PARTICULAR PURPOSE. IN NO EVENT SHALL THE END USER BE ENTITLED TO ANY CONSEQUENTIAL, INCIDENTAL OR CONTINGENT DAMAGES OF ANY KIND ARISING OUT OF BREACH OF CONTRACT, WARRANTY (INCLUDING NEGLIGENCE AND STRICT LIABILITY) OR OTHER THEORIES OF LAW, WITH RESPECT TO PRODUCTS SOLD OR SERVICES RENDERED BY KENCO, OR ANY UNDERTAKINGS, ACTS OR OMISSIONS RELATING THERETO.